

RevPlus

Brand new responsive
template for PrestaShop

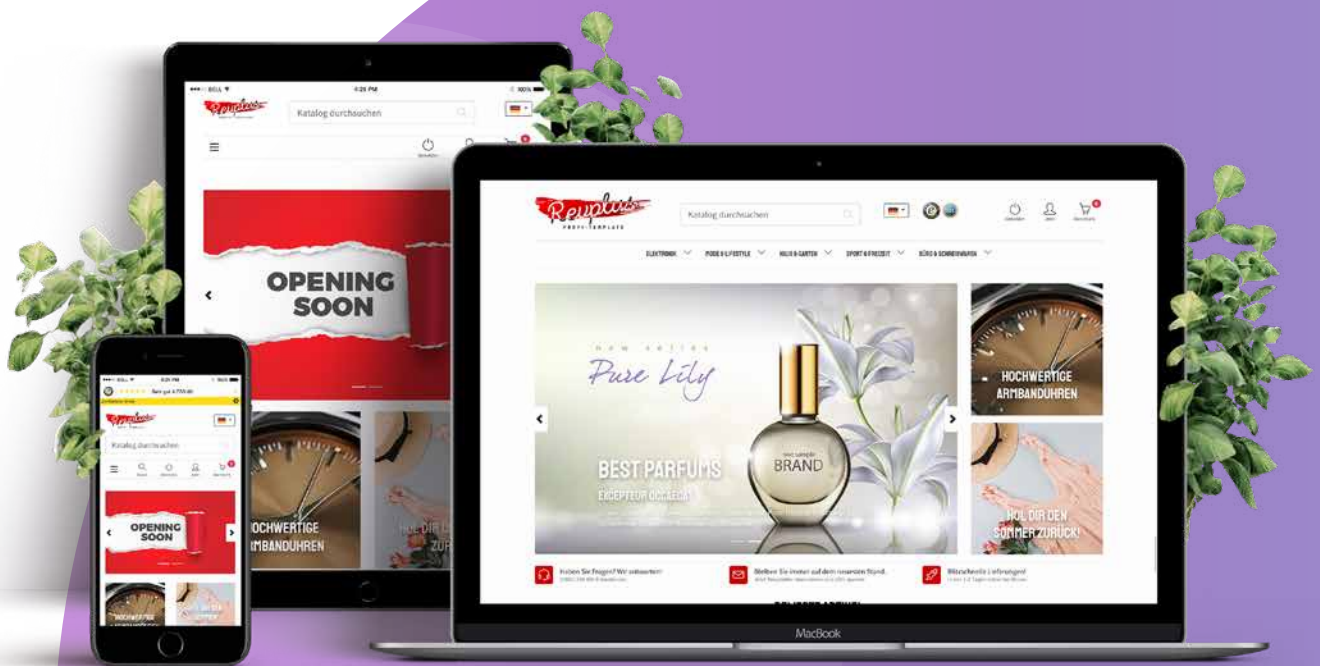

THEMEN

Foreword	2
Explanation of terms	3
Contents of the ZIP file	4
Before installation	5
Disable Cache	5
Activate maintenance mode	5
Deactivate additional modules	6
Installing the theme	7
1) Upload & install additional module	7
2.1) Uploading the theme (direct upload)	7
2.2) Uploading the Theme (Backend Upload)	8
3) Activating the theme	8
Hooks & other modules	10
Additional Hooks	10
Zuordnung der Module	10
Customisation	12
Customize colors	12
Bearbeiten Der CSS-Datei	12
Child-Theme	13
Contact us	14
Consulting, Contract & Technical Support	14
Legal	14

FOREWORD

A warm welcome! Congratulations on purchasing the RevPlus professional template for PrestaShop from FIETZ GmbH & Co. KG. In the following you will learn, which requirements must be fulfilled for use and what has to be observed and how to install, configure and operate the template under PrestaShop.

EXPLANATION OF TERMS

In order to be able to explain your new theme in more detail, and so that you can master the handling of the theme later, some technical terms must be clarified in advance.

Please note: These statements are mainly relevant for the German market. In English the terms are mostly self-explanatory.

Term	Description
Backend / Backoffice	The <i>backend</i> , also called <i>backoffice</i> in PrestaShop, is the <i>configuration</i> or <i>admin interface</i> of your shop system. Here you can manage orders, customers, contact data and much more.
Frontend / Frontoffice	The <i>frontoffice</i> (or <i>frontend</i>) is your shop as your customers can see it.
Checkout	The <i>checkout</i> is the <i>checkout area</i> of your shop. This is where your customers enter their contact details and confirm their order.
Content	The <i>content</i> describes the <i>content</i> of your page. This can consist of text, images, products or other elements.
Sidebar	The <i>sidebar</i> is a <i>sidebar</i> that can be found in the <i>frontend</i> of your shop. It can be located to the right or left of the <i>main content</i> .
Hook	A <i>hook</i> is like an <i>anchor</i> in the code that is passed during program execution and provides the ability to execute external code snippets from modules.
http(s)	The H yper- T ext T ransfer P rotocol (S ecure) is responsible for the transmission and display of web pages. This protocol can only be used to read shared files. The addition „Secure“ stands for the use of an <i>SSL certificate</i> on the website.
FTP	FTP stands for F ile T ransfer P rotocol. Unlike <i>http(s)</i> , for example, this protocol can also be used to send files to the server.
Client	The <i>client</i> describes the <i>end user</i> or <i>visitor</i> of a page. Files are downloaded from the Internet from the <i>server</i> to the <i>client</i> in order to display web pages or edit files.
Drag & Drop	This term describes the <i>dragging</i> of files or elements with the mouse over the screen.

CONTENTS OF THE ZIP FILE

In addition to the actual template, the ZIP file also contains a module that extends the configuration options of the RevPlus theme. This module is also supplied as a ZIP file to enable installation via the PrestaShop backend.

In addition, of course, the RevPlus theme itself is also delivered. This is not packaged and can be uploaded via an *FTP client* such as FileZilla (Windows, Mac) or WinSCP (Windows). If you have problems connecting to your server or have not received access data to an *FTP server*, please contact your provider.

- shoproot
- modules
 - ↳ fietz_revplus_preferences.zip
- themes
 - RevPlus
 - ↳ assets
 - ↳ config
 - ↳ modules
 - ↳ plugins
 - ↳ templates
 - ↳ translations
- Installation-RevPlus-DE.pdf
- Installation-RevPlus-EN.pdf

BEFORE INSTALLATION

Please make the following settings before installation to avoid errors during installation of the module and theme.

DISABLE CACHE

1. In the backend, navigate to the navigation point **Advanced Settings > Performance**.
2. Disable all caches and set template compilation to **Recompile templates if the files have been updated** or **Force compilation** (our recommendation).
3. Click the **Clear Cache** button.

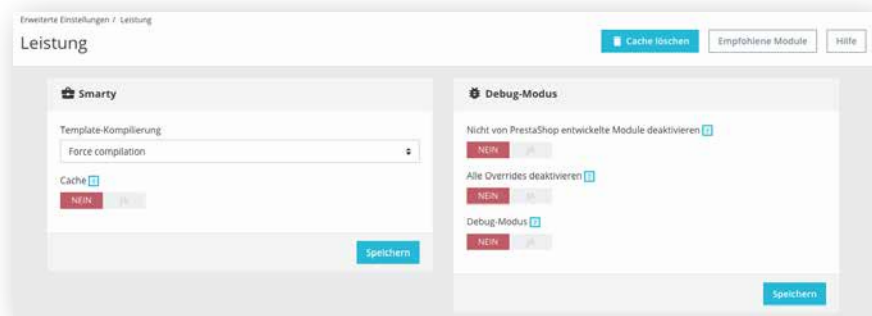

ACTIVATE MAINTENANCE MODE

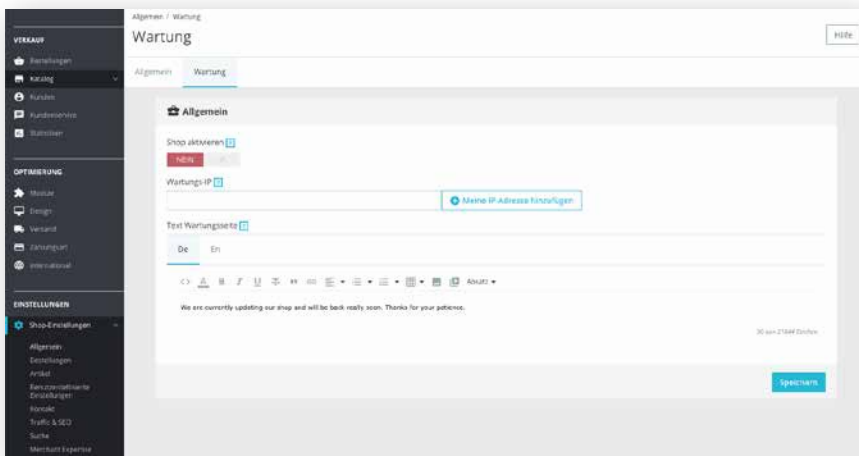

If you're wanted to avoid downtimes of your shop, e.g. because you are working on a live system, you should activate the *maintenance mode*. Proceed as follows:

1. Navigate in the backend to **Shop settings > General > Maintenance**
2. If necessary, enter your IP address here to avoid having to enter an admin password.
3. If necessary, enter a text for your visitors so that they can see that you will soon be online again.

DEACTIVATE ADDITIONAL MODULES

1. Navigate in the *backend* to **Modules > Modules & Services** and deactivate all modules that are not included in PrestaShop.

Notice

Payment and shipping modules are generally not affected. If you are still unsure, deactivate these modules as well.

INSTALLING THE THEME

Here we finally come to the topic that everyone has been waiting for... The installation.

1) UPLOAD & INSTALL ADDITIONAL MODULE

The first step is to upload and install the module supplied by us. This step is **not optional** as the module is dependent on the RevPlus theme and is required for error-free display. Proceed as follows to install the module:

1. Navigate in the backend to **Modules > Modules & Services**
2. Click on the **Upload Module** button in the top right-hand corner
3. *Drag and drop* the ZIP file **fietz_revplus_preferences.zip** onto the browser window or navigate to the same file in the file explorer and click on „open“.

If no error occurs, PrestaShop should display a success message after a few seconds. After this step you can already click on **Settings** in the module to adjust colors and text - if you are wanted to do this now.

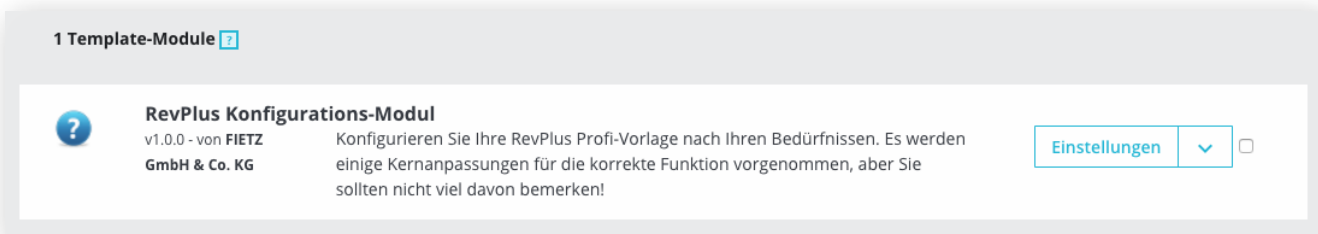

If an error message is displayed, please contact us at support@fietz-medien.de.

2.1) UPLOADING THE THEME (DIRECT UPLOAD)

To upload the theme, you need an *FTP client*, such as WinSCP (Windows), or FileZilla (Windows, Mac). If you do not know the FTP access data to your server, please contact your provider. If you are not familiar with an FTP program, we recommend the procedure in the next point: **2.2) Uploading the theme (backend upload)**.

Otherwise, proceed as follows to upload the theme via *FTP*:

1. Connect to your server via *FTP*.
2. Navigate on the server to your PrestaShop installation and there to **/themes**.
3. On your local PC, navigate to the Theme folder: **/shoproot/themes**.
4. Upload the **RevPlus** directory.

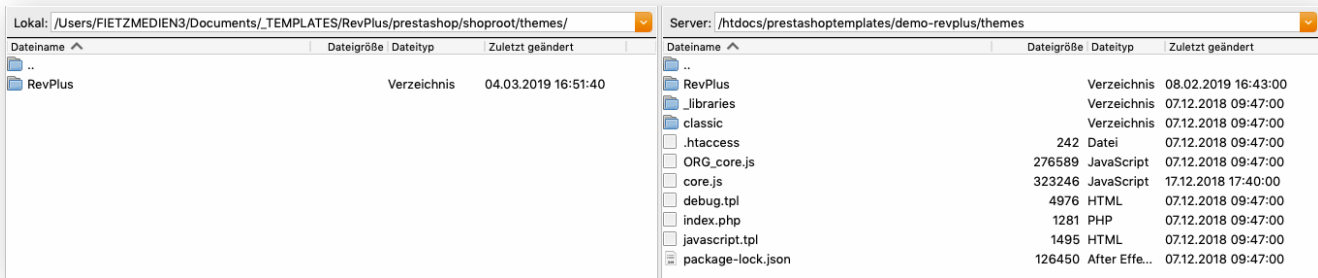

2.2) UPLOADING THE THEME (BACKEND UPLOAD)

i Notice

This possibility is unfortunately not yet available!

3) ACTIVATING THE THEME

Everything is now ready to activate the theme. In the add-on module, you can make a few settings concerning the color, font and display of the theme.

1. Navigate to **Design > Template & Logo**.
2. Click at the bottom of the page on **Activate this template** for the RevPlus theme.
3. Adapt the logo and the favicon if necessary!

You can now also define other layouts for certain pages. A full width layout is available which does not contain a page column and can display five product boxes next to each other in the listing at full screen size.

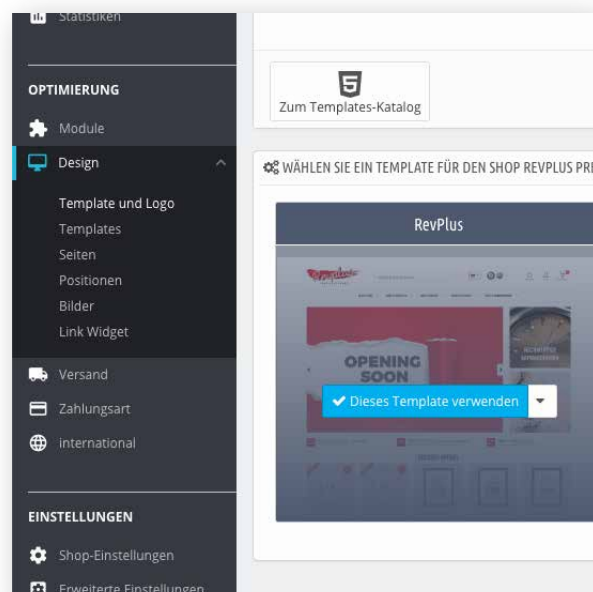

A sidebar-left layout is also available, which displays a sidebar on the left and four product boxes next to each other in the listing at full screen resolution. This layout is already activated as default for the product listing in the category view.

In order to adapt the layouts for further areas, the RevPlus template must already be activated. Now click on the **Select Layout** button and adjust the views for the corresponding areas as desired.

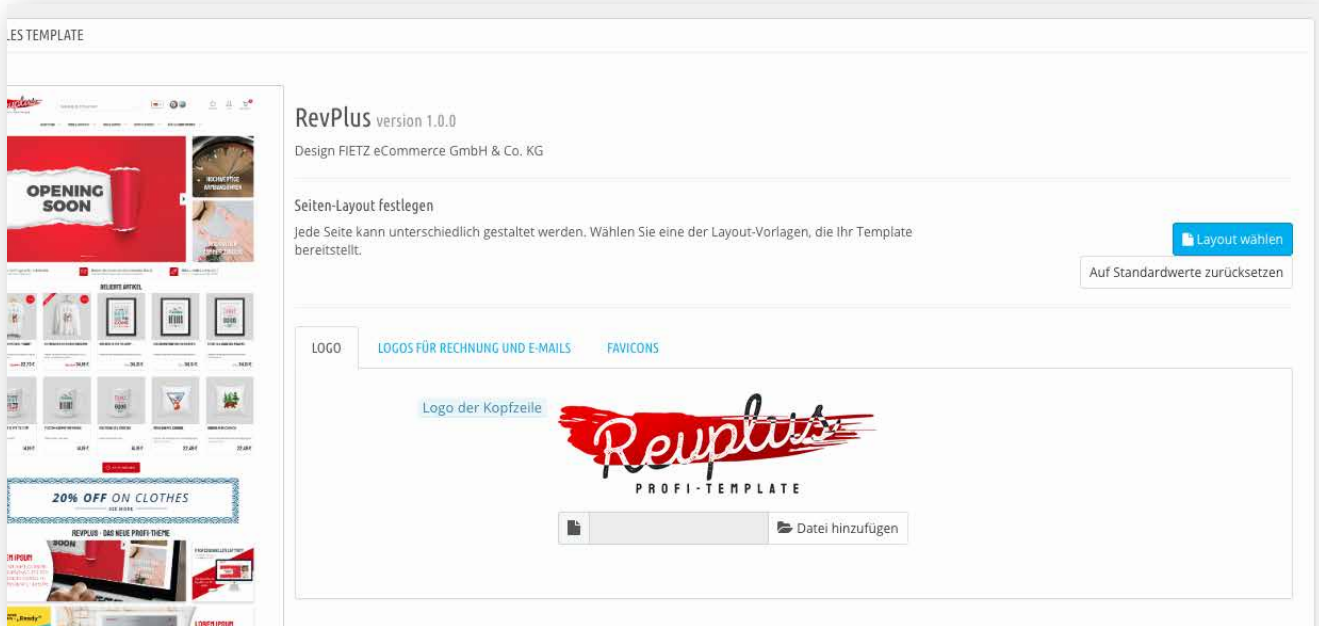

The screenshot shows the PrestaShop theme editor interface for the RevPlus template. On the left, there is a preview of the template's homepage with various promotional banners and product listings. The main area displays the 'RevPlus version 1.0.0' settings page, designed by FIETZ eCommerce GmbH & Co. KG. The 'Seiten-Layout festlegen' (Set page layout) section allows users to choose a layout for each page, with a 'Layout wählen' button and an option to 'Auf Standardwerte zurücksetzen' (Reset to default values). Below this, the 'LOGO' section is active, showing a red 'Revplus' logo with 'PROFI-TEMPLATE' underneath. There are tabs for 'LOGOS FÜR RECHNUNG UND E-MAILS' and 'FAVICONs', and a 'Datei hinzufügen' (Add file) button.

HOOKS & OTHER MODULES

PrestaShop offers a whole range of additional modules. These are placed on certain hooks in the template by default during installation. These hooks are usually included in the theme, so the installation of new modules should not cause any problems. Nevertheless, there are a few additional hooks in the RevPlus theme to improve the display and make more features available for the theme.

ADDITIONAL HOOKS

- **displayHomeSlider** The Image-Slider module is moved to this hook to allow the display of banners next to the slider.
- **displayHomeBanner** Shows additional banners next to the image slider. These banners can be edited using the RevPlus add-on module.
- **displayHomeQuickService** Displays an additional area under the image slider and the additional banners on the home page that highlights special services of your shop. The processing of this area is so far only possible via FTP!
- **displayFooterColumn[1-4]** Four footer columns are displayed in the footer of the template. On each of these four columns any modules can be placed for output.
- **displayFooterSeo** A SEO text can be inserted below the footer columns. This text can only be edited via the RevPlus add-on module!

ZUORDNUNG DER MODULE

When the theme is installed or activated, certain modules are assigned to certain hooks. Most of them follow the standard of the Classic theme, which is delivered by PrestaShop, or the default of the module itself.

A module, however, which is probably used by most shop operators, must be manually assigned to one of the newly created hooks. This is the ps_linklist module. To display this in the frontend, follow these instructions:

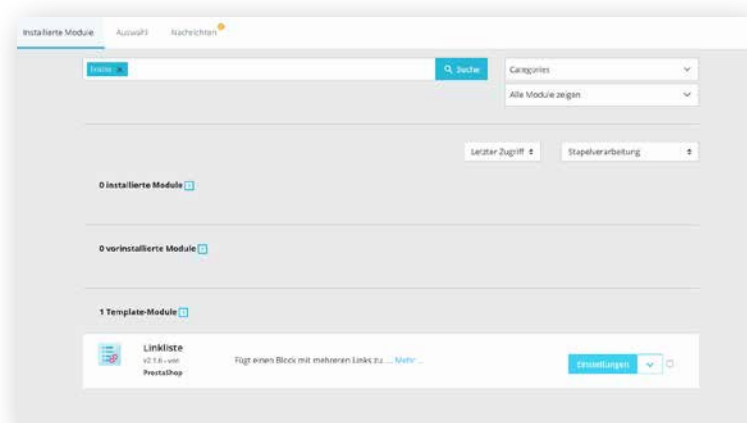

1. Navigate in the backend to **Modules > Modules & Services > Link List > Settings**
2. Click on **Edit** in the displayed link list areas.
3. To display the link list in the Footer, select one of the Footer columns: **displayFooterColumn[1-4]** (recommendation: **displayFooterColumn1**)

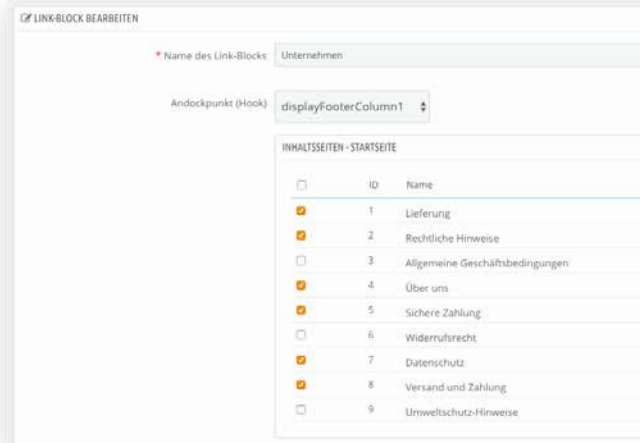

CUSTOMISATION

You can adapt your RevPlus theme relatively easily, independently and completely individually. In most cases an individualisation makes sense to set your shop apart from others.

CUSTOMIZE COLORS

The colour management of the RevPlus theme is quite simple thanks to the additional module supplied. When you save your changed colors in the module, additional color contrasts and shades are automatically generated and output as CSS in the frontend. It is a bit more difficult, if the generated colors do not correspond to the ideas in the result. To counteract this, knowledge of CSS is necessary. You can overwrite all existing CSS rules by editing the **custom.css** file in the template.

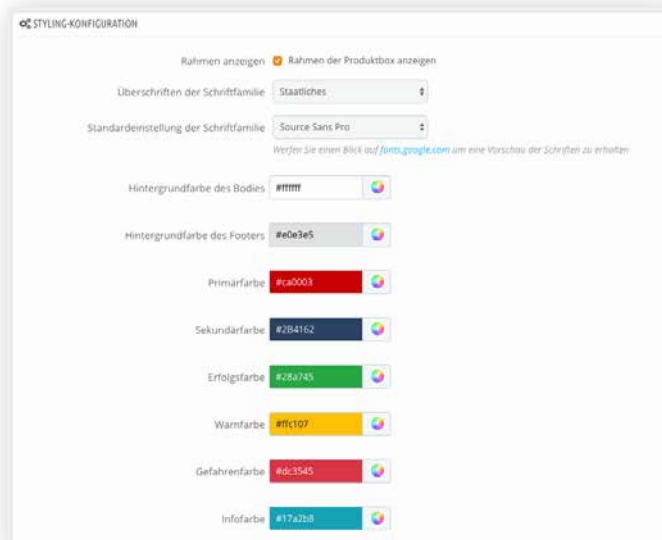

BEARBEITEN DER CSS-DATEI

In the CSS file not only colors can be adjusted, but also font sizes, thicknesses, distances and much more. However, many CSS statements can have different effects on the frontend. If you have no experience with CSS, we recommend that you have the changes made by an expert. Please contact support@fietz-medien.de for more information.

To edit the CSS file, follow these steps:

1. Connect to your server via *FTP*.
2. Navigate to your PrestaShop installation and there to **/themes/RevPlus/assets/css**.
3. Open the **custom.css** file.
4. Insert your CSS statements and save the file.

CHILD-THEME

If the RevPlus theme does not meet your expectations at all in some respects, there is still the possibility of creating a so-called child theme. This makes use of the folder structure of the parent theme and overwrites files with the same paths with its own files. In this way, even after extensive customization, most themes remain updateable and no longer overwrite the changes made.

We recommend that only real professionals create child themes to avoid long downtimes in case of errors! For more information on child themes, please visit the [PrestaShop Developer Documentation](#).

CONTACT US

You can reach our telephone support **Monday - Thursday 09.00 to 17.00 hrs** and **Friday 09.00 to 15.00 hrs**.

On weekends, holidays and technical failures please use the **support by e-mail**. Here you get fast and competent help.

Our support address: support@fietz-medien.de

Please note that we can **only** provide our support to **customers with a legally acquired and valid license** to use the RevPlus theme!

CONSULTING, CONTRACT & TECHNICAL SUPPORT

You don't want to configure your RevPlus Profi-Template yourself, or you want to have something completely individual? As an experienced eCommerce agency we help you with the management and marketing of your online shop. Get your individual offer today!

Phone. (0800) 25 04 050 (free of charge)

E-mail. support@fietz-medien.de

LEGAL

FIETZ GmbH & Co. KG

Schlepegrellstrasse 54
29223 Celle
Germany

Commercial registry

Amtsgericht (local court) Lüneburg
Register sheet HRA: 202840

CEO

Immo W. Fietz

Tax No.

17/202/82606

VAT ID

according to § 27a UStG: DE315034944

Personally liable partner

FIETZ.MEDIEN GmbH
CEO: Immo W. Fietz

Commercial registry
Amtsgericht (local court) Lüneburg,
HRB 200953